

Huw Meredydd Owen a selection of projects



Tyddyn Môn, Amlwch 1999-2002

Development of farm as an improved destination (=place) culminating in a network of paths and a series of arts commissions by a number of well known artists, in two phases; farm operated by adults with learning disabilities



Dwylo Da, Penygroes 2002

Commissioning of a mural (by a young Bedwyr Williams) as part of a placemaking process for new childcare facility. (Building also designed by me).

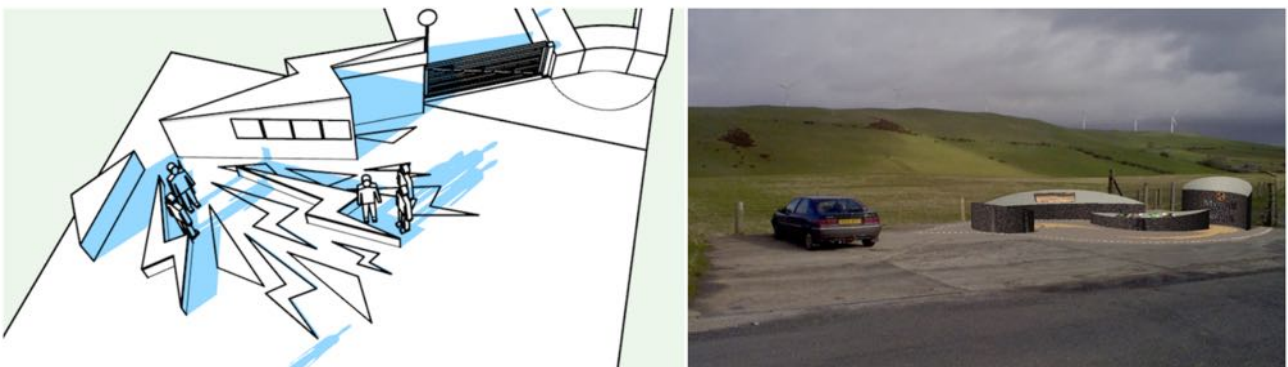

Mynydd Gôrddu, Aberystwyth 2003

information point for a wind farm (on a nearby hillside) in north Cardiganshire drawing attention to the benefits of clean and sustainable energy

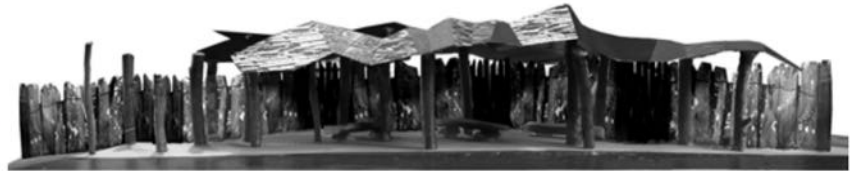

Sherpa, Snowdon 2003 - 2004

for the Snowdonia Green Key Initiative; design of a series of timber and copper-roofed site-specific bus shelters in and around Snowdonia National Park, to encourage greater use of public transport; link with local poets. *With Pandora Vaughan.*



Museum of the Seaside, Rhyl 2004

Dramatic reinvention of a poor commercial building to provide visitors with a layered experience of Rhyl in its heyday, and also a fully accredited museum for the collection and touring exhibitions. *Unbuilt.*

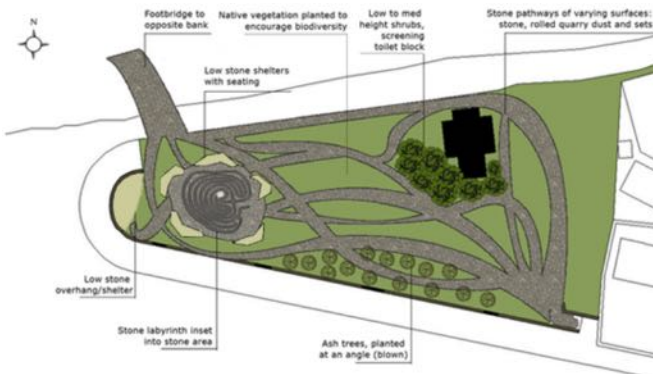

Queens, Aberdaron 2005

Public consultation and placemaking design for coastal defence land into new landscape and facilities. *Unbuilt.*



Denbigh County Hall 2005

Feasibility of making the old county hall and courts building into a certified museum by making the building its main artifacts, transforming the nature of the 'place' from what had become a 1980s megastructure internally. *With Susan Dalloe.*



Llwybr Iauws, Cwellyn, Snowdon 2005 - 2007

for Snowdonia National Park Authority. Commissioned to create a boardwalk route with disabled access as a sculptural landscape work with false perspective jetty, installations and multiple-choice portals.



Cywain, Bala 2000 - 2009

for Antur Penllyn. Landscape design, exhibition design, signage, and artworks (scheme as a whole designed by me). *With Pandora Vaughan.*



TBOWS, Bournemouth 2010

design and construction of a flexible outdoor learning, social and performance environment in the school. Part of the ACE Creative Partnerships scheme. *With Pandora Vaughan.*



Llanrwst Station 2010 - 2015

Using the intrinsic significance of an old station (new journeys; new beginnings; connection with the wider world) to develop a location for economic and educational activities for young people in the area, particularly in Welsh.

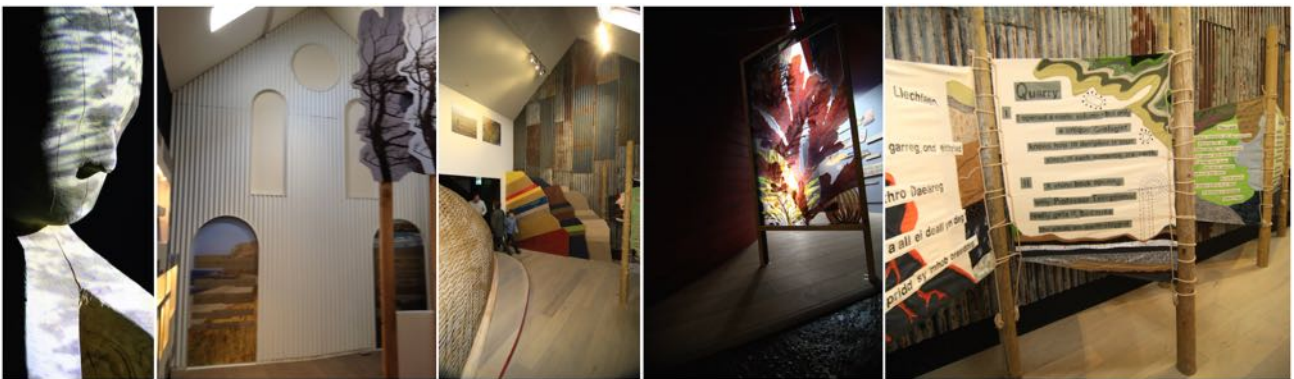

Porth y Swnt, Aberdaron 2011 - 2014

Interpretive experience for a new National Trust visitor centre, working with the community, and a number of artists. Individual works also produced by V&O. *With Pandora Vaughan and Susan Dalloe.*



Old Lime Kiln Site, Abersoch 2013-2014

Interpretation point for the coastal trade, making the location a feature of the presentation due to its links with the ships that would load and offload on the nearby beach. *With Susan Dalloe.*



Carmel, Anelog 2014 - current

Refurbishment of a historic chapel, needing to emphasise its relationship to the community and to become a destination in its own right, to be achieved by large scale artwork. *With Susan Dalloe.*

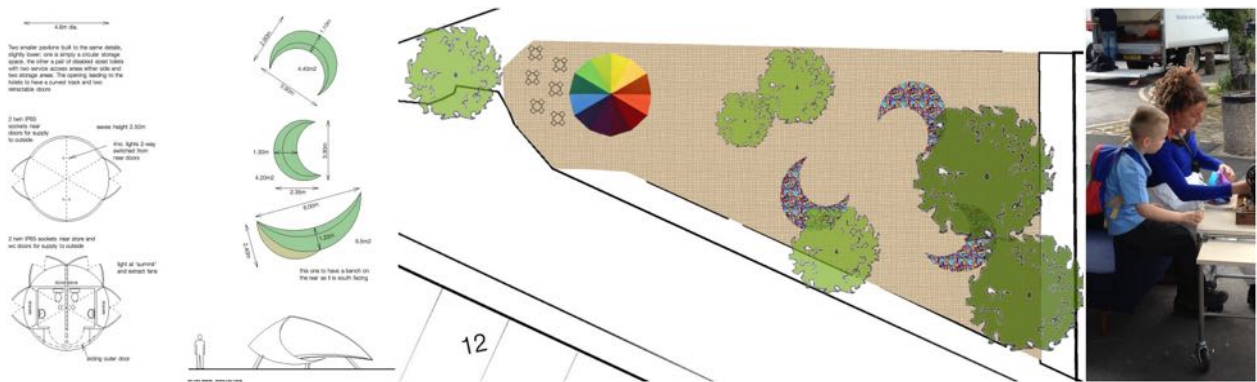

Maindee, Newport 2016

Using art activities and interventions as a catalyst for regeneration, as part of ACW 'Ideas People Places' programme.



Ingestre Orangery 2016

Interpretation Plan and design for early 19Cent. Orangery in the grounds of Ingestre Hall, Staffordshire, exploring and emphasising the movement of the visitor around the site. *With Susan Dalloe*



Samuel Johnson Birthplace Museum Lichfield 2018

Review of this museum in a house in the centre of the cathedral city. Supported by enthusiastic volunteers and able staff, the museum is looking for a new take on interpretation starting with a review. *With Susan Dalloe.*

Details of many of the above projects, and further photos are available on my website which is updated from time to time.

huwmeredyddown.com